

SI3250P • SI3350P • SI3600P

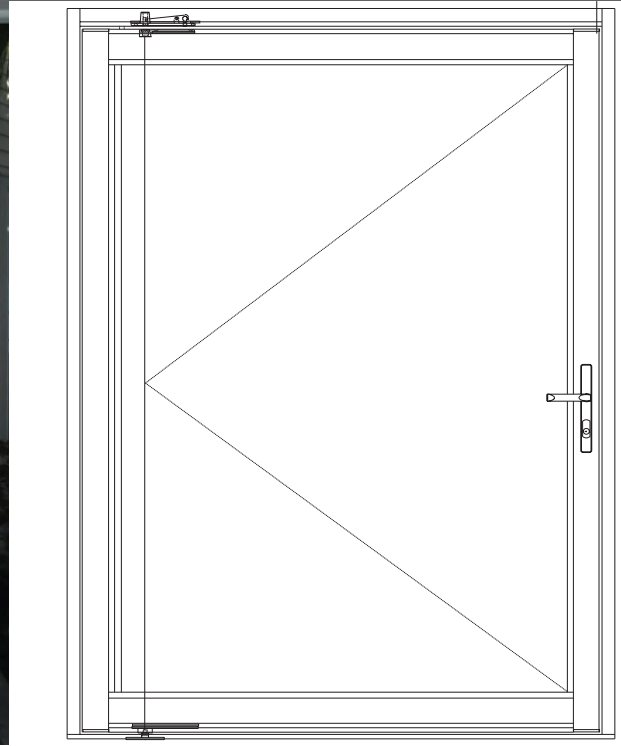

Series SI3000P thermally enhanced aluminum pivot doors can be used in commercial and residential applications. System design offers exceptional air, water, structural, and thermal performance in any condition. Multiple sill options and profile dimensions provide greater performance and design flexibility. Customization of product profiles, hardware, sills, panel size, and testing can be completed upon request.

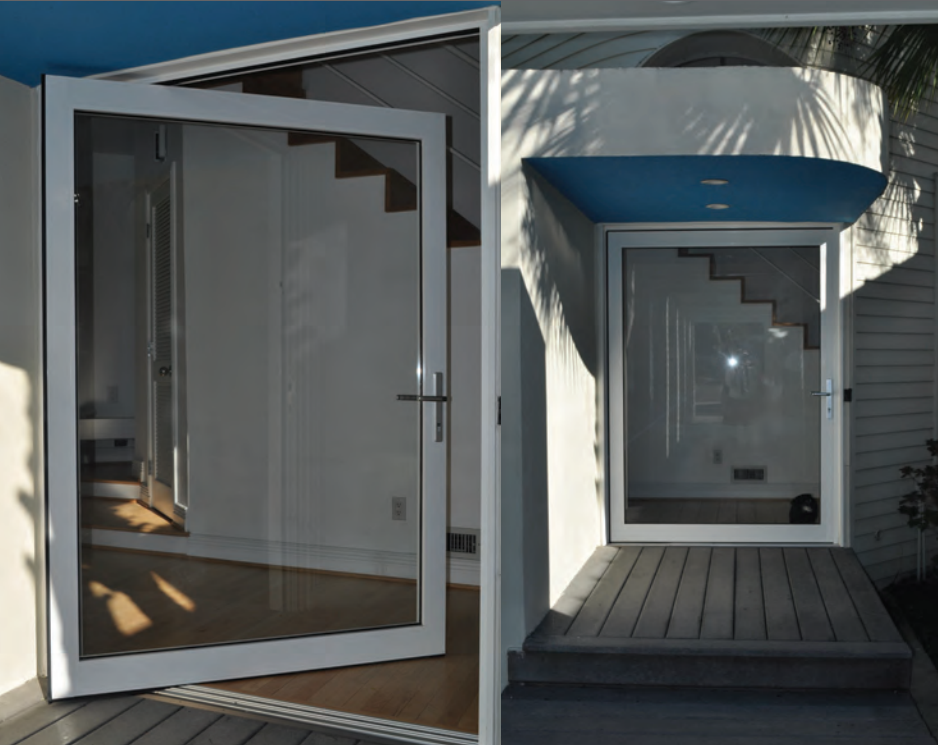
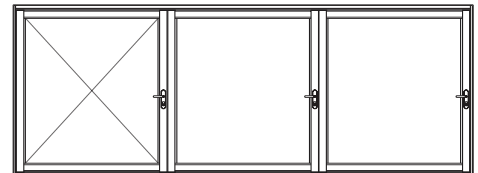
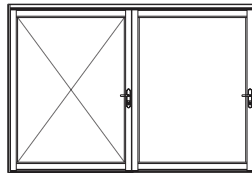
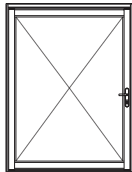

## Features:

- Thermally enhanced utilizing thermal strut
- Maximum panel size 4' x 8'. Larger sizes available dependent upon engineering requirements
- Multiple hardware styles and finishes
- Accommodates monolithic and insulated glazing infills from 3/16" to 1 1/8"
- Standard finishes: AAMA 2603
  - Duracron: Hartford Green, Bronze, Black, Natural Clay, White, Sandstone
- Left, right, or center pivot options
- Minimum 12" distance from center of pivot point to edge of either jamb\*
- In-swing, out-swing, and dual acting
- LEED friendly system including recycled content
- Designed and manufactured in the U.S.A.

## Options:

- Matching fixed transoms and sidelites
- Custom finishes
  - Class I anodized: Dark Bronze, Clear
  - Powder coat finish: AAMA 2604-2605
  - Fluoropolymer (50% or 70%): AAMA 2604-2605
  - Veneer and cladding options
  - Dual color or dual finish options
- Decorative interior and exterior grids
- Self actuating closers
- Multiple sill designs, including ADA compliant ramps and sill-less options
- Factory installed sill drain tubes, if required
- Designed to accommodate almost any monolithic, insulated, laminated, decorative, polycarbonate, or solid panel infill

\* Pivot locations for doors wider than 60" must be located further from the jamb at a location approximately 20% or greater than the width of the door panel.



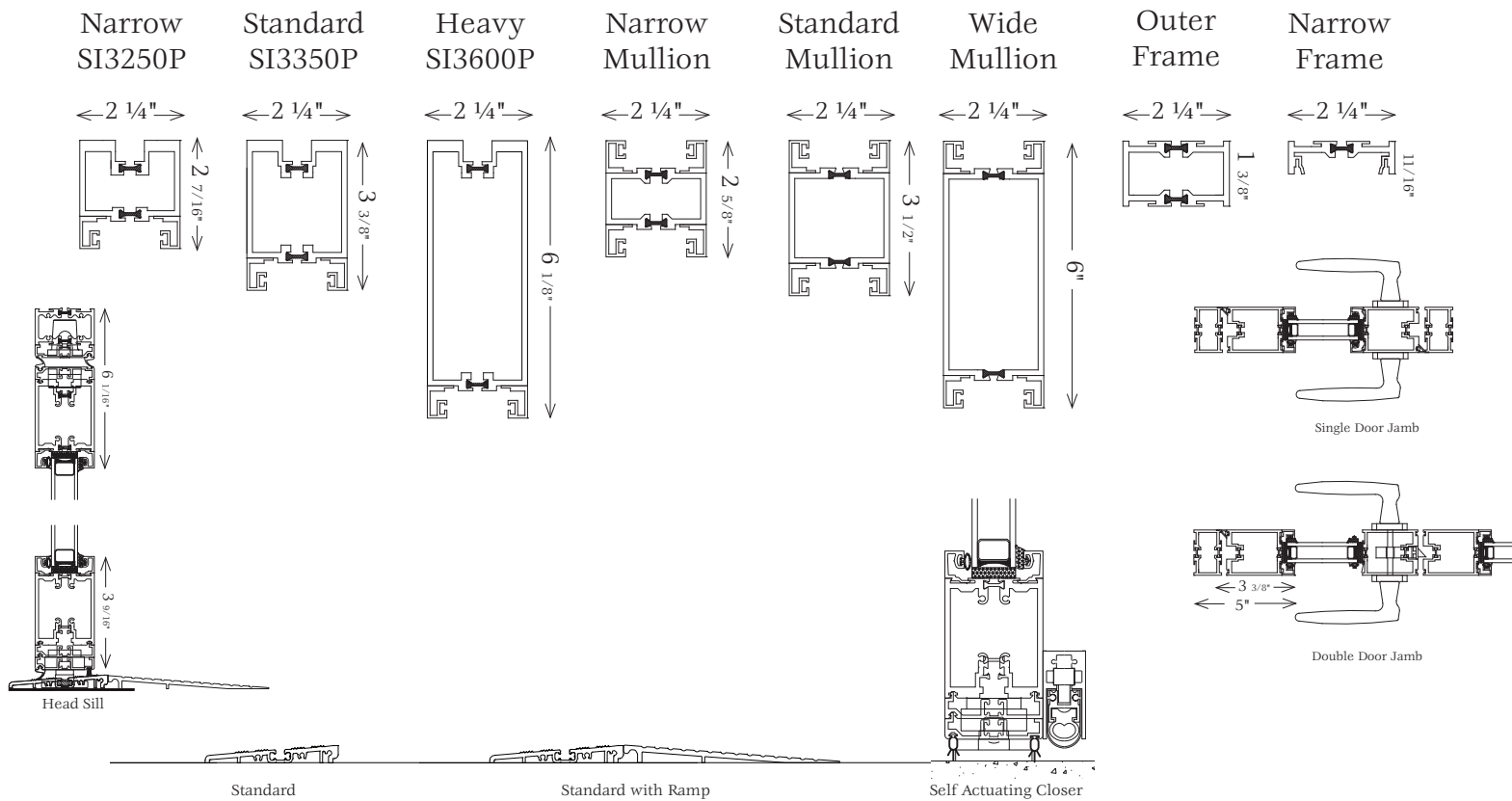

Due to the operational loads of pivot doors, Solar Innovations, Inc. recommends that pivot doors be set on concrete or wood substrates only. Failure to do so may void warranty. Solar Innovations recommends pivot locations be a minimum of 12" from either jamb. Pivot locations for doors wider than 60" must be located further from the jamb at a location approximately 20% or greater than the width of the door panel.

### Coastal Applications

#### Back Plate Options



#### Brass Handle Options



#### Color Options

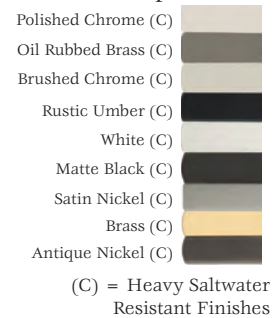

### Inland Applications

#### Back Plate Options



Both styles available with:  
 Thumb - Interior  
 Lever - Exterior  
 Lever - Interior  
 Lever - Exterior  
 Thumb - Interior  
 Keyed Exterior

#### Solid Brass Handle Options



#### Color Options



#### Aluminum Handle Options

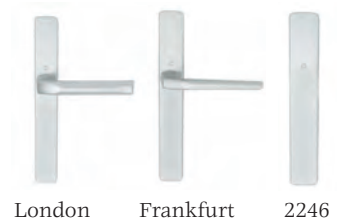

#### Aluminum Color Options

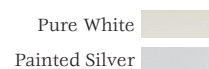

**Please Note:** All hardware options are subject to vendor availability. Solar Innovations, Inc. reserves the right to discontinue any hardware option at any time. Solar Innovations, Inc. can achieve a 13psf or greater water performance with additional sill selections. Testing and performance results may vary depending upon sill and hardware selections. Please be sure to visit our website for additional product information.

[www.solarinnovations.com](http://www.solarinnovations.com)

